

CVUSD | *Facilities Master Plan*

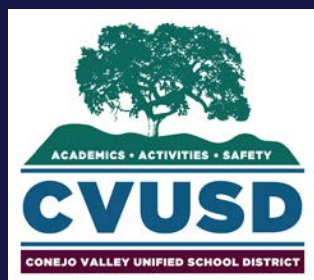

CVUSD - WESTLAKE CLUSTER



Conejo Elementary School | *Alternate Concepts*

280 North Conejo School Road | Thousand Oaks, CA 91362
Conejo Valley Unified School District
March 31, 2017

NAC Architecture
837 North Spring Street, 3rd Floor
Los Angeles, CA 90012
Contact: 323.475.8075
E-mail: lochoa@nacarchitecture.com
Website: www.nacarchitecture.com



Challenges Summary:

- Topography presents accessibility, safety and site drainage challenges
- Campus building infrastructure and finishes are aging
- Classroom furniture systems and technology do not meet the school's needs
- Play structures are aging
- Evenly distributed and age-specific restrooms are lacking
- Campus perimeter security is lacking
- Main entry gate configuration is compressed
- Main administrative offices are undersized

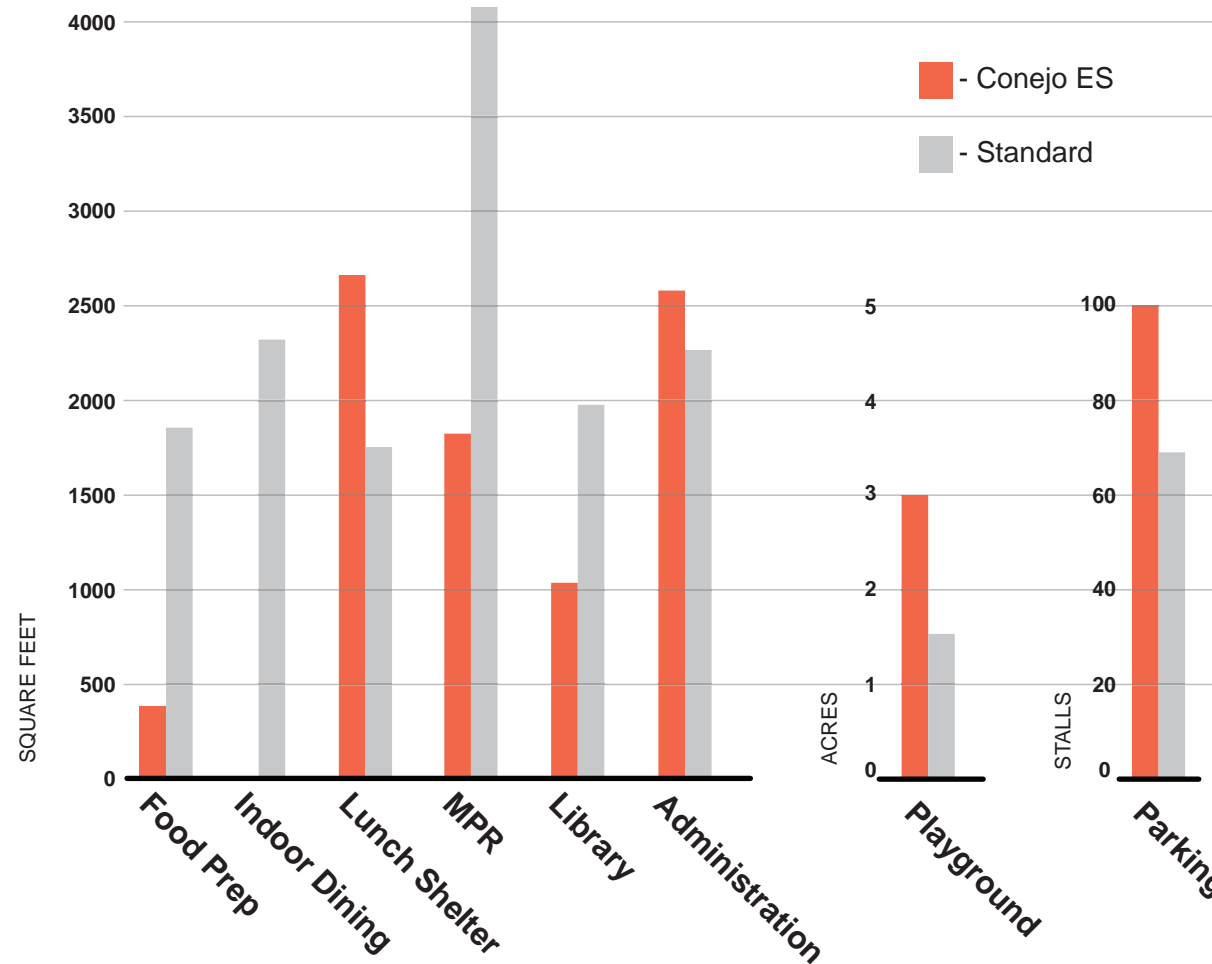

Core Facilities Summary

Current facilities meet school's needs

- Food Prep (-1,254 SF)
- Indoor Dining (-2,640 SF)
- Lunch Shelter (+810 SF)
- Playground (+1.34 Acres)

Current facilities DO NOT meet school's needs

- Multi-Purpose Room (-2,363 SF)
- Library (-810 SF)
- Administration (+455 SF)
- Parking (+24 Stalls)

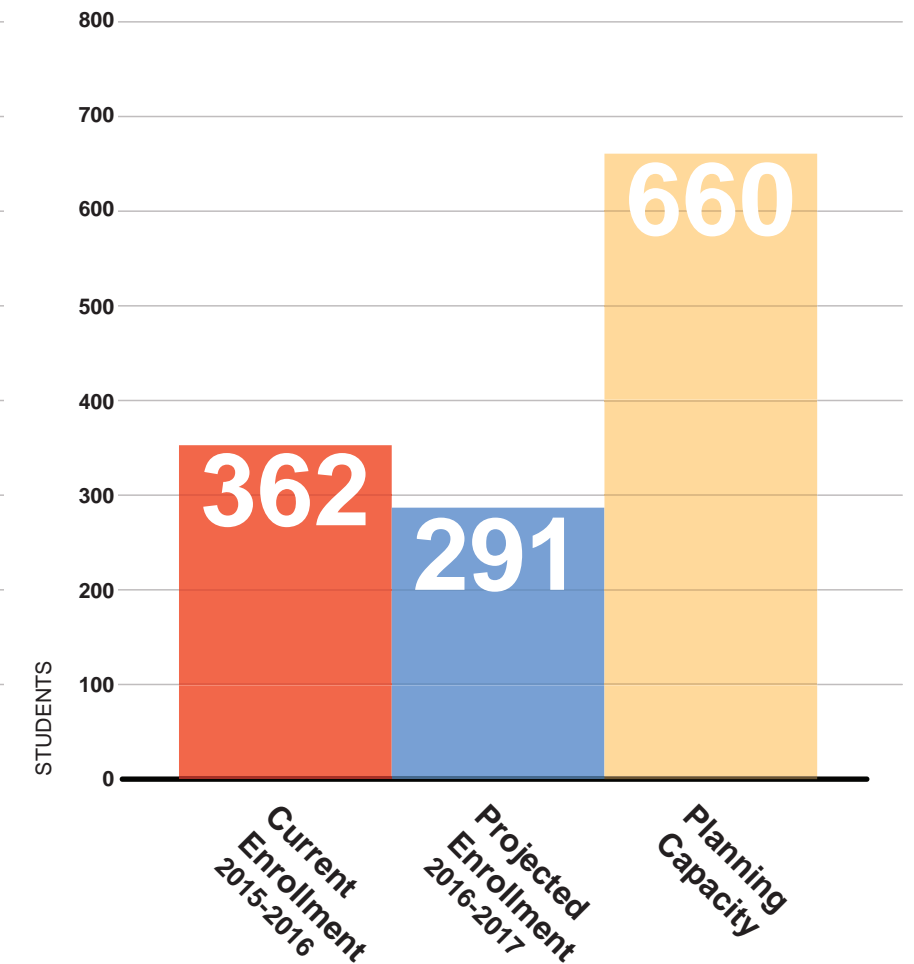

Enrollment Summary

Total Current Classrooms: 25
 Total Based on Projected Enrollment Classrooms: 15

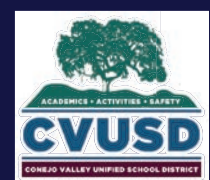

Conejo Elementary School | Alternate Concepts

280 N Conejo Road | Thousand Oaks, CA 91362
 Conejo Valley Unified School District
 March 31, 2017

Enrollment & Facilities Data

LEGEND

- Existing Building (No Work)
- New Construction
- High Modernization
- Medium Modernization
- Low Modernization
- Structure Above
- x Building Number
- "P" Indicates Portable
- x Indicates Uncertified

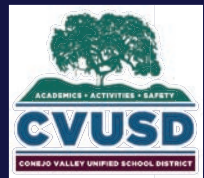
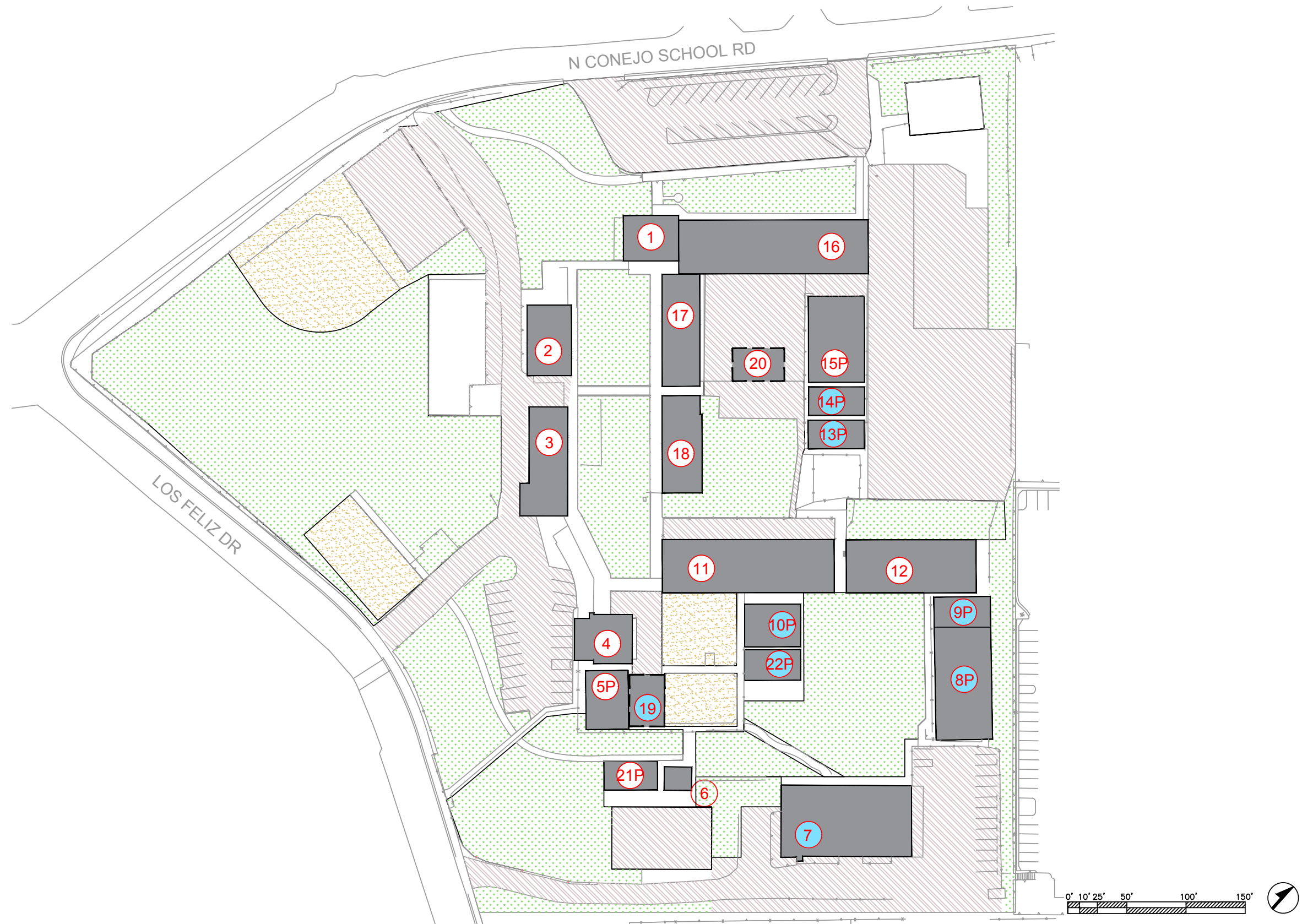

Conejo Elementary School | *Alternate Concepts*

280 N Conejo Road | Thousand Oaks, CA 91362
 Conejo Valley Unified School District
 March 31, 2017

Existing Conditions

LEGEND

- Existing Building (No Work)
- New Construction
- High Modernization
- Medium Modernization
- Low Modernization
- Structure Above
- x Building Number
- "P" Indicates Portable
- x Indicates Uncertified

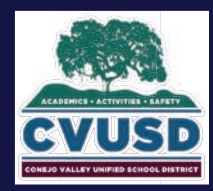
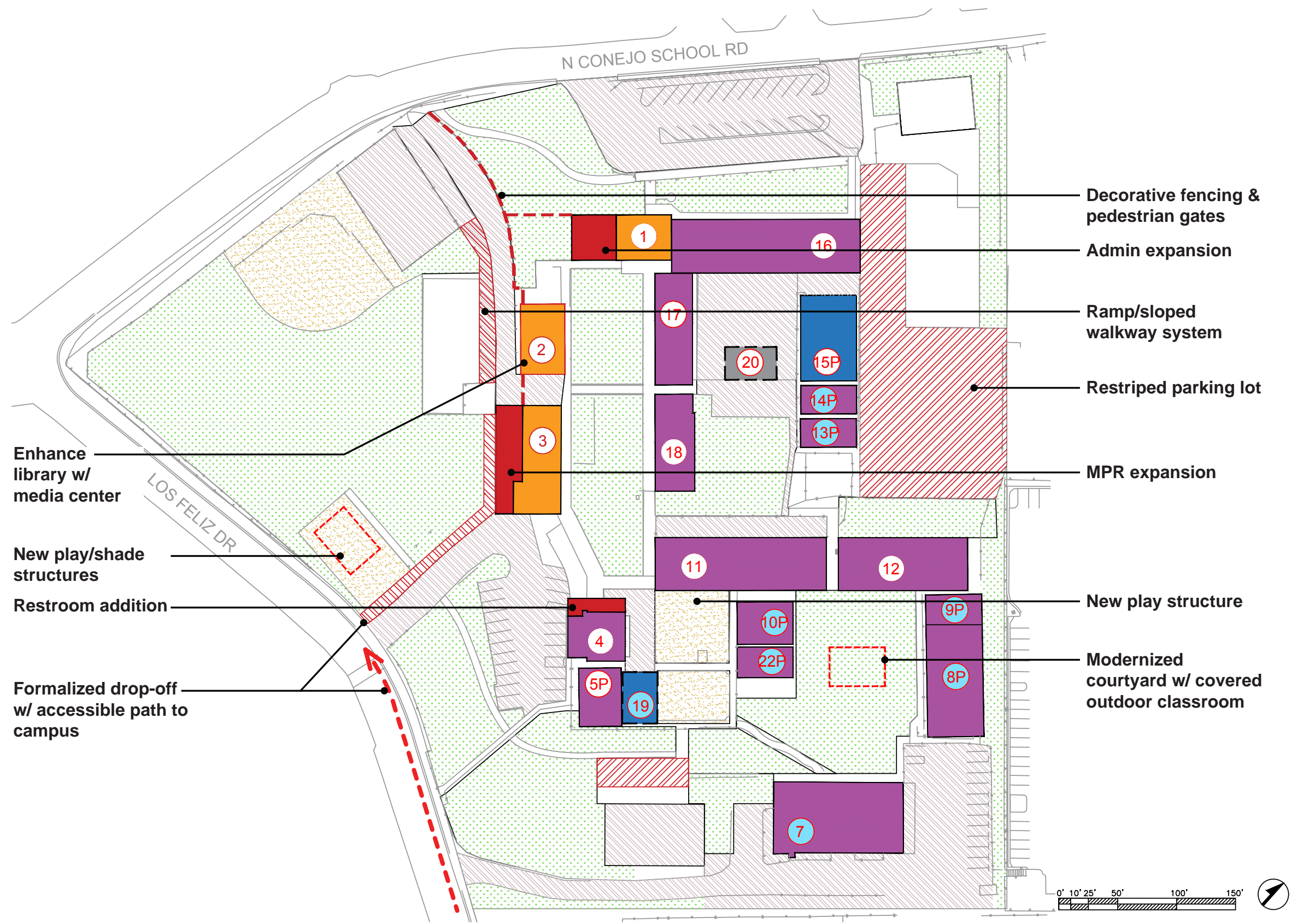

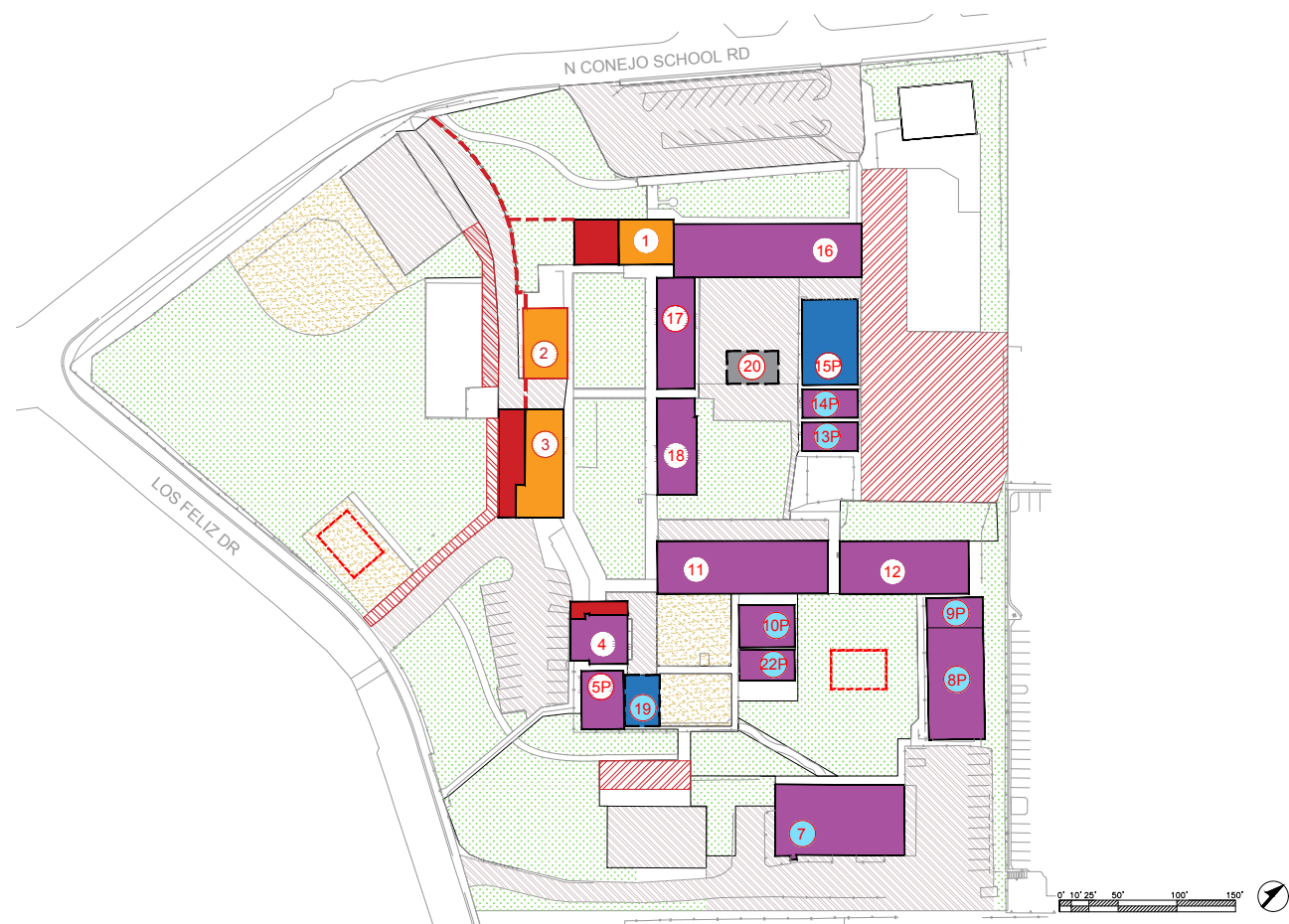

Alternate Concept 1

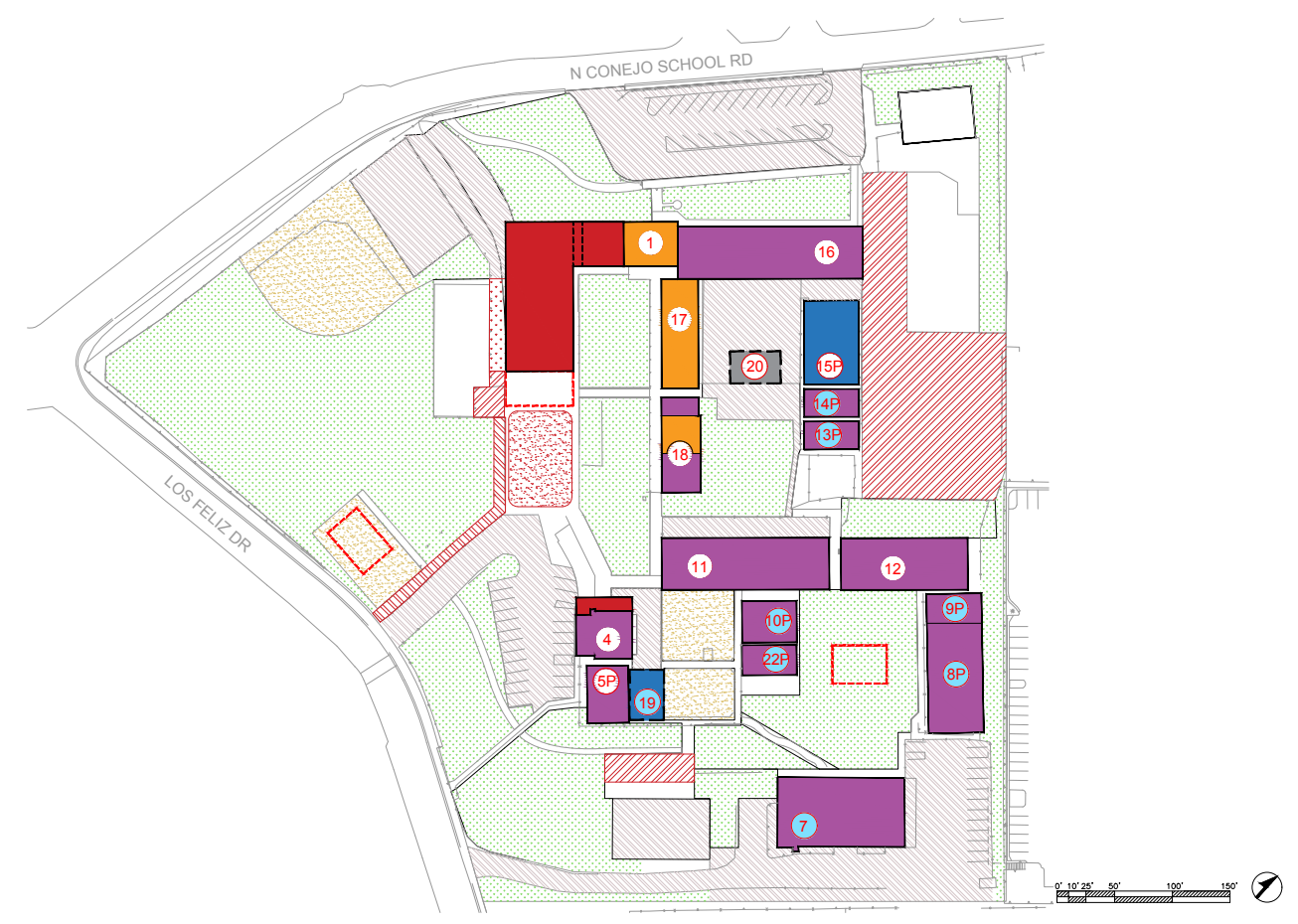

Alternate Concept 2

Project Scope:

- Expansion of admin spaces & MPR/Food Service
- Modernization of existing Bldg 2 admin spaces for library/media center
- Restroom addition to Building 4
- DSA certification of all buildings
- Replacement of play structures, addition of shade structures & enhanced courtyards
- Expanded/restriped parking lots & dedicated drop-off
- Decorative fencing & pedestrian gates
- General accessibility upgrades, including ramp system at fields

Project Scope:

- New MPR/Food Service Building with admin expansion & lunch shelter
- Modernization of existing Bldg 17 spaces for library/media center
- Modernization of existing Bldg 18 computer classroom for flex classroom
- Restroom addition to Building 4
- DSA certification of all buildings
- Replacement of play structures, addition of shade structures & enhanced courtyards
- Expanded/restriped parking lots & dedicated drop-off
- Decorative fencing & pedestrian gates
- General accessibility upgrades, including ramp system at fields

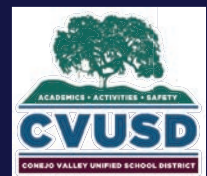

Conejo Elementary School | *Alternate Concepts*

280 N Conejo Road | Thousand Oaks, CA 91362
 Conejo Valley Unified School District
 March 31, 2017

Summary

Description	Quantity	Unit	Count	Total	Unit Cost	Total Cost
Conejo ES (Alternate Concept 1)						
Administration Expansion	1,465	SF	1	1,465	\$450.00	\$ 659,250.00
MPR Expansion	1,885	SF	1	1,885	\$480.00	\$ 904,800.00
Restroom Addition	600	SF	1	600	\$875.00	\$ 525,000.00
Existing Bldgs - Modernization (high)	6,037	SF	1	6,037	\$270.00	\$ 1,629,990.00
Existing Bldgs - Modernization (medium)	36,340	SF	1	36,340	\$126.00	\$ 4,578,840.00
Existing Bldgs - Modernization (light)	4,230	SF	1	4,230	\$13.00	\$ 54,990.00
Shade Structures	3,010	SF	1	3,010	\$80.00	\$ 240,800.00
Play Equipment	2	EA	1	2	\$60,000.00	\$ 120,000.00
Decorative Fencing/Gates	2,060	LF	1	2,060	\$210.00	\$ 432,600.00
Access Improvements	1	LS	1	1	\$120,000.00	\$ 120,000.00
<i>Parking/Drop-off Reconfiguration</i>						
restroom Addition	17,210	SF	1	17,210	\$12.00	\$ 206,520.00
Drop-off Lane	241	LF	1	241	\$780.00	\$ 187,980.00
Total Construction Cost						\$ 9,660,770.00
Total Project Cost						\$ 13,525,078.00

Description	Quantity	Unit	Count	Total	Unit Cost	Total Cost
Conejo ES (Alternate Concept 2)						
New MPR/Food Service/Admin. Expansion	9,270	SF	1	9,270	\$480.00	\$ 4,449,600.00
Restroom Addition	600	SF	1	600	\$875.00	\$ 525,000.00
Existing Bldgs - Modernization (high)	4,438	SF	1	4,438	\$270.00	\$ 1,198,260.00
Existing Bldgs - Modernization (medium)	30,798	SF	1	30,798	\$126.00	\$ 3,880,548.00
Existing Bldgs - Modernization (light)	2,880	SF	1	2,880	\$13.00	\$ 37,440.00
Shade Structures	3,010	SF	1	3,010	\$80.00	\$ 240,800.00
Play Equipment	2	EA	1	2	\$60,000.00	\$ 120,000.00
Courtyard Improvements	4,490	SF	1	4,490	\$8.00	\$ 35,920.00
Decorative Fencing/Gates	2,060	LF	1	2,060	\$210.00	\$ 432,600.00
Access Improvements	1	LS	1	1	\$120,000.00	\$ 120,000.00
<i>Parking/Drop-off Reconfiguration</i>						
AC Paving	17,210	SF	1	17,210	\$12.00	\$ 206,520.00
Drop-off Lane	241	LF	1	241	\$780.00	\$ 187,980.00
Total Construction Cost						\$ 11,434,668.00
Total Project Cost						\$ 16,008,535.20

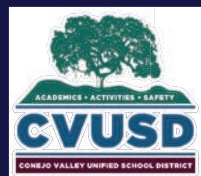

Conejo Elementary School | *Alternate Concepts*

280 N Conejo Road | Thousand Oaks, CA 91362
 Conejo Valley Unified School District
 March 31, 2017

Cost Evaluations